

9827/9828/9860 SERIES

Floating B to B Type Connector



- 0.8mm pitch
- Floating range $\pm 0.5\text{mm}$ in X, Y, Z directions
- Variety of Line up

The 9827/9828/9860 series is a 0.8mm-pitch SMT, BtoB connector with floating function. It is applicable for Car electronics, Infrastructure, Industrial machine and all variety of applications. It has a wide variety of Line up (Connecting type and height) to choose from. This is a standard item that already shipped over 340 Million pcs, since 2001.

Features

- Floating range is $\pm 0.5\text{mm}$ in X, Y, Z directions can be advantage in customer assembling.
- Line-up of Right angle, Parallel (Stacking) type and variety of height, so it can be freely designed.
- Compliant with RoHS

Specifications

| | | |
|----|-----------------------|-----------------------------|
| 1 | Series No. | 9827 / 9828 / 9860 |
| 2 | Pitch | 0.8mm |
| 3 | No. of contacts | 30~120P |
| 4 | Mating Height | 6.00~24.70mm |
| 5 | Current rating | 0.5A |
| 6 | Voltage rating | 50V |
| 7 | D.W voltage | 250V |
| 8 | Insulation Resistance | 500M Ω |
| 9 | Contact Resistance | 100m Ω or below |
| 10 | Operating Temperature | -40~+105 $^{\circ}\text{C}$ |
| 11 | Floating Range | $\pm 0.5\text{mm}$ |
| 12 | Plating | Au plating |

Website







http://www.iriso.co.jp/en/product_series/9827/



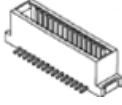



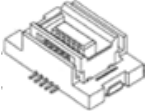

http://www.iriso.co.jp/en/product_series/9828/

http://www.iriso.co.jp/en/product_series/9860/

9827/9828/9860 SERIES

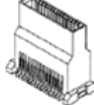
Mating Height Metrics

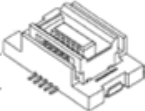
| SOCKET \ PLUG | | 9827B SMT | 9827B SMT | 9827B SMT | 9828B SMT |
|---------------|---|---|---|---|--|
| | |  |  |  |  |
| | | 4.8mm | 6.8mm | 7.8mm | - |
| | | Y953(Z13-GFC) | Y954(Z14-GFC) | Y955(Z15-GFC) | Y921(N-GFC) |
| 9827S SMT |  | 6.0mm | 8.0mm | 9.0mm | |
| | | 4.95mm | | | |
| Y926(Z09-GF) | | 5.5~6.5 | 7.5~8.5 | 8.5~9.5 | |
| 9828S SMT |  | 9.75mm | 11.75mm | 12.75mm | Vertical (ST-RA) |
| | | 8.45mm | | | |
| Y922(Z07-GF) | | 9.25~10.25 | 11.25~12.25 | 12.25~13.25 | - |

| SOCKET \ PLUG | | 9860B SMT | 9860B SMT | 9860B SMT | 9860B SMT | 9860B SMT | 9860B SMT |
|---------------|---|---|---|---|--|---|---|
| | |  |  |  |  |  |  |
| | | 10.95mm | 13.05mm | 14.55mm | 15.8mm | 17.65mm | 19.75mm |
| | | Y509(Z17-GFA) | Y947(Z09-GFC) | Y912(Z14-GFA) | Y940(Z07-GFC) | Y508(Z16-GFA) | Y921(Z18-GFA) |
| 9827S SMT |  | 12.15mm | 14.25mm | 15.75mm | 17.0mm | 18.85mm | 20.95mm |
| | | 4.95mm | | | | | |
| Y926(Z09-GF) | | 11.65~12.65 | 13.75~14.75 | 15.25~16.25 | 16.5~17.5 | 18.35~19.35 | 20.45~21.45 |
| 9828S SMT |  | 15.9mm | 18.0mm | 19.5mm | 20.75mm | 22.6mm | 24.7mm |
| | | 8.45mm | | | | | |
| Y922(Z07-GF) | | 15.4~16.4 | 17.5~18.5 | 19.0~20.0 | 20.25~21.25 | 22.1~23.1 | 24.2~25.2 |

9827/9828/9860 SERIES

IMSA-9827S-**-□-□□

SERIES 9827 SOCKET

| CKT | PART No. | A | B | C | D | E |
|-----|----------------|------|------|------|------|------|
| 30 | 9827S-30Z04-GF | 21.0 | 15.8 | 11.2 | 20.8 | 18.0 |
| 40 | 9827S-40Z04-GF | 25.0 | 19.8 | 15.2 | 24.8 | 22.0 |
| 50 | 9827S-50Z04-GF | 29.0 | 23.8 | 19.2 | 28.8 | 26.0 |
| 60 | 9827S-60Z04-GF | 33.0 | 27.8 | 23.2 | 32.8 | 30.0 |
| 70 | 9827S-70Z04-GF | 37.0 | 31.8 | 27.2 | 36.8 | 34.0 |
| 80 | 9827S-80Z04-GF | 41.0 | 35.8 | 31.2 | 40.8 | 38.0 |

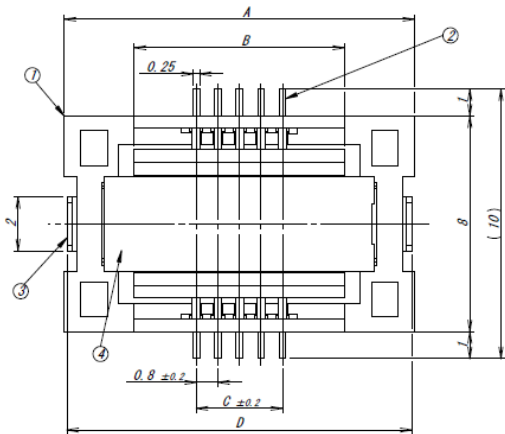

NOTE
1. コプラナリティ/ COPLANARITY : 0.1MAX.

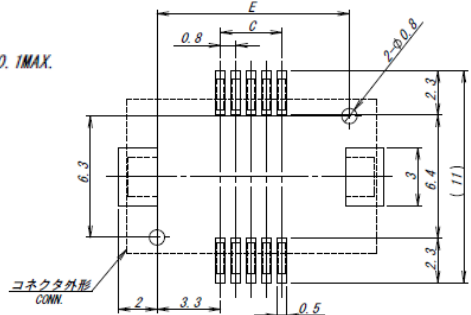
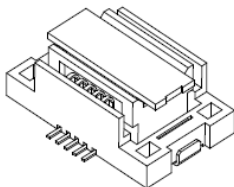

推奨基板寸法
一般公差 : ±0.05 (マウント面)
RECOMMENDED PCB SIZE
GENERAL TOLERANCE : ±0.05 (MOUNTING SIDE)

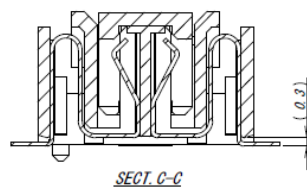
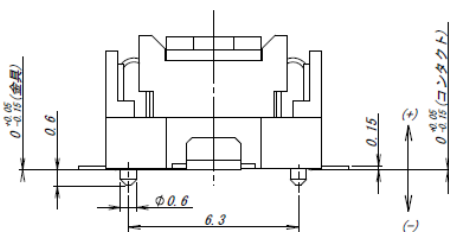
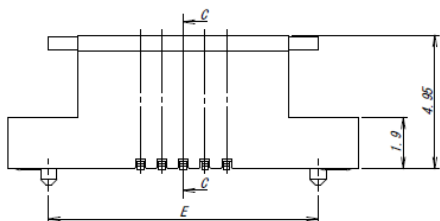

IMSA-9827B-**-□-□□

SERIES 9827 PLUG

| CKT | PART No. | A | B | C | D | E |
|-----|----------------|------|------|------|------|------|
| 30 | 9827B-30J-GFC | 11.2 | 13.0 | 14.4 | 16.3 | 16.1 |
| 40 | 9827B-40J-GFC | 15.2 | 17.0 | 18.4 | 20.3 | 20.1 |
| 50 | 9827B-50J-GFC | 19.2 | 21.0 | 22.4 | 24.3 | 24.1 |
| 60 | 9827B-60J-GFC | 23.2 | 25.0 | 26.4 | 28.3 | 28.1 |
| 70 | 9827B-70J-GFC | 27.2 | 29.0 | 30.4 | 32.3 | 32.1 |
| 80 | 9827B-80J-GFC | 31.2 | 33.0 | 34.4 | 36.3 | 36.1 |
| 90 | 9827B-90J-GFC | 35.2 | 37.0 | 38.4 | 40.3 | 40.1 |
| 100 | 9827B-100J-GFC | 39.2 | 41.0 | 42.4 | 44.3 | 44.1 |
| 110 | 9827B-110J-GFC | 43.2 | 45.0 | 46.4 | 48.3 | 48.1 |
| 120 | 9827B-120J-GFC | 47.2 | 49.0 | 50.4 | 52.3 | 52.1 |

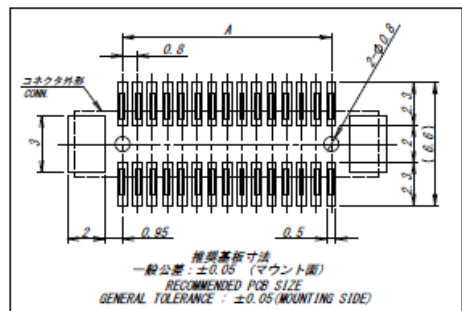
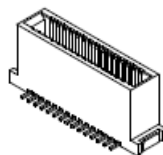
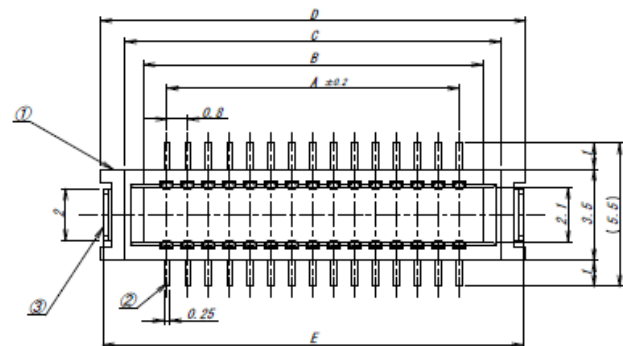

推奨基板寸法
一般公差 : ±0.05 (マウント面)
RECOMMENDED PCB SIZE
GENERAL TOLERANCE : ±0.05 (MOUNTING SIDE)

NOTE
1. コプラナリティ : 0.1MAX.

NOTE
1. COPLANARITY : 0.1MAX.

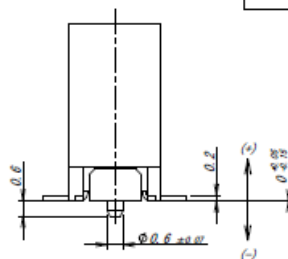
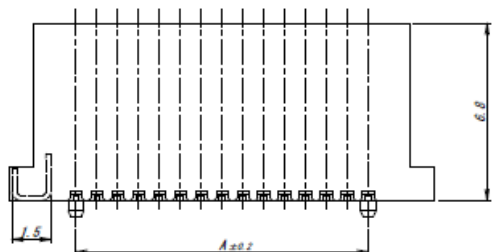

9827/9828/9860 SERIES

IMSA-9828S-**□-□□

SERIES 9828 SOCKET

| CKT | PART No. | A | B | C | D | E |
|-----|-----------------|------|------|------|------|------|
| 30 | 9828S-30Z04-GF | 11.2 | 12.9 | 21.0 | 20.8 | 18.0 |
| 40 | 9828S-40Z04-GF | 15.2 | 16.9 | 25.0 | 24.8 | 22.0 |
| 50 | 9828S-50Z04-GF | 19.2 | 20.9 | 29.0 | 28.8 | 26.0 |
| 60 | 9828S-60Z04-GF | 23.2 | 24.9 | 33.0 | 32.8 | 30.0 |
| 70 | 9828S-70Z04-GF | 27.2 | 28.9 | 37.0 | 36.8 | 34.0 |
| 80 | 9828S-80Z04-GF | 31.2 | 32.9 | 41.0 | 40.8 | 38.0 |
| 90 | 9828S-90Z04-GF | 35.2 | 36.9 | 45.0 | 44.8 | 42.0 |
| 100 | 9828S-100Z04-GF | 39.2 | 40.9 | 49.0 | 48.8 | 46.0 |
| 110 | 9828S-110Z04-GF | 43.2 | 44.9 | 53.0 | 52.8 | 50.0 |
| 120 | 9828S-120Z04-GF | 47.2 | 48.9 | 57.0 | 56.8 | 54.0 |

NOTE
1. コプラナリティー/COPLANARITY : 0.1MAX.

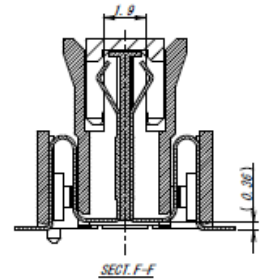
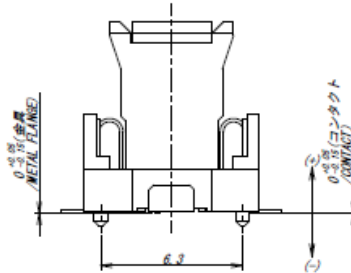
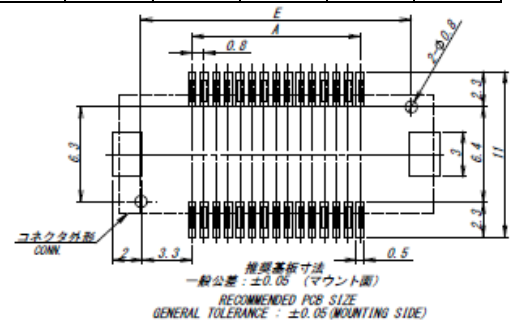
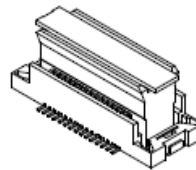
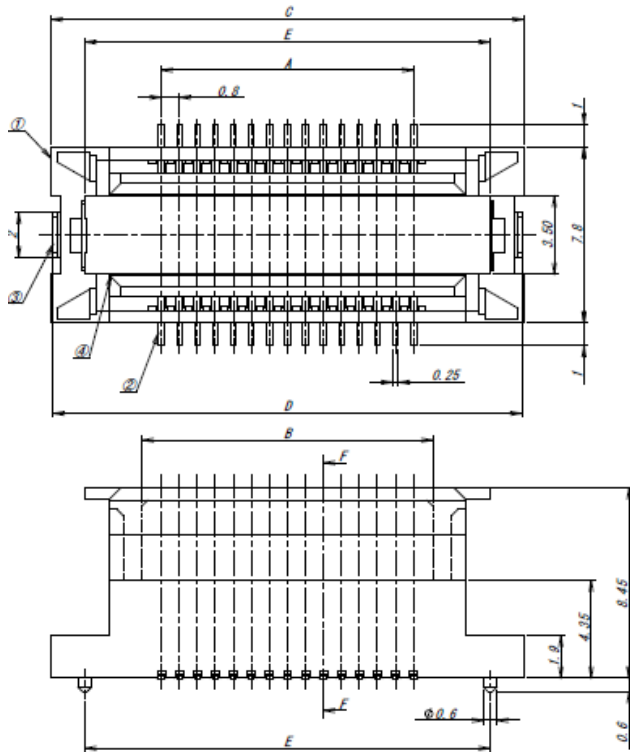

IMSA-9828B-**□-□□

SERIES 9828 PLUG

| CKT | PART No. | A | B | C | D | E |
|-----|---------------|------|------|------|------|------|
| 30 | 9828B-30D-GFC | 11.2 | 13.0 | 14.4 | 21.0 | 14.7 |
| 40 | 9828B-40D-GFC | 15.2 | 17.0 | 18.4 | 25.0 | 18.7 |
| 50 | 9828B-50D-GFC | 19.2 | 21.0 | 22.4 | 29.0 | 22.7 |
| 60 | 9828B-60D-GFC | 23.2 | 25.0 | 26.4 | 33.0 | 26.7 |
| 70 | 9828B-70D-GFC | 27.2 | 29.0 | 30.4 | 37.0 | 30.7 |
| 80 | 9828B-80D-GFC | 31.2 | 33.0 | 34.4 | 41.0 | 34.7 |
| 90 | 9828B-90D-GFC | 35.2 | 37.0 | 38.4 | 45.0 | 38.7 |

NOTE
1. コプラナリティー/COPLANARITY : 0.1MAX. (CKT-30~90)
0.15MAX. (CKT-100~120)

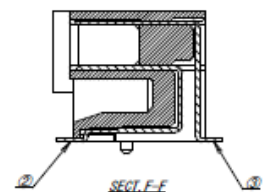
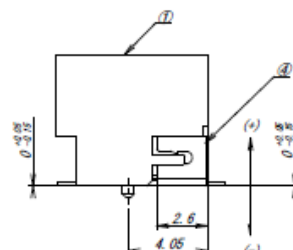
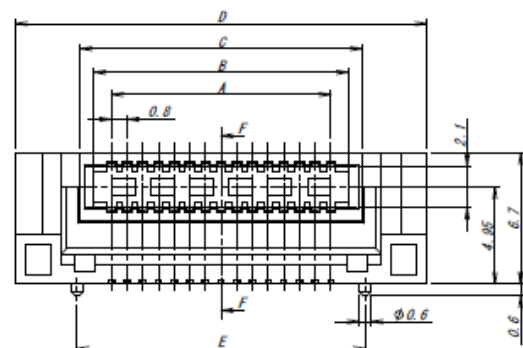
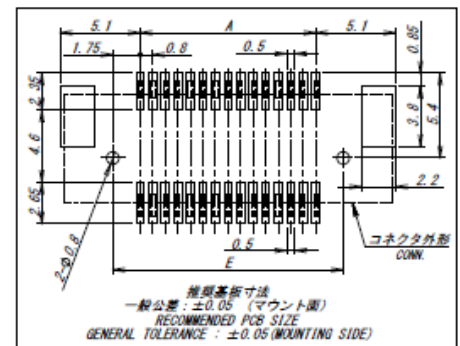
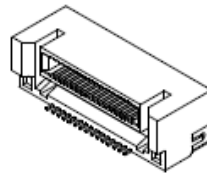
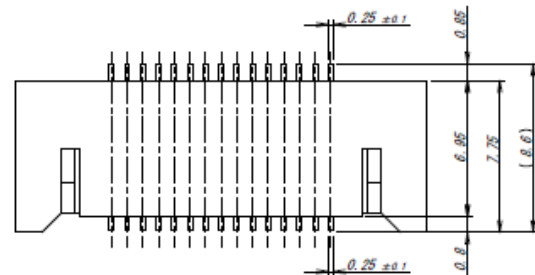

9827/9828/9860 SERIES

IMSA-9860B-**-□-□□

SERIES 9860 PLUG

| CKT | PART No. | A | B | C | D | E | F |
|-----|------------------|------|------|------|------|------|------|
| 30 | 9860B-30Z03-GFC | 11.2 | 13.0 | 13.7 | 16.3 | 16.1 | 15.0 |
| 50 | 9860B-50Z03-GFC | 19.2 | 21.0 | 21.7 | 24.3 | 24.1 | 23.0 |
| 80 | 9860B-80Z03-GFC | 31.2 | 33.0 | 33.7 | 36.3 | 36.1 | 35.0 |
| 100 | 9860B-100Z03-GFC | 39.2 | 41.0 | 41.7 | 44.3 | 44.1 | 43.0 |

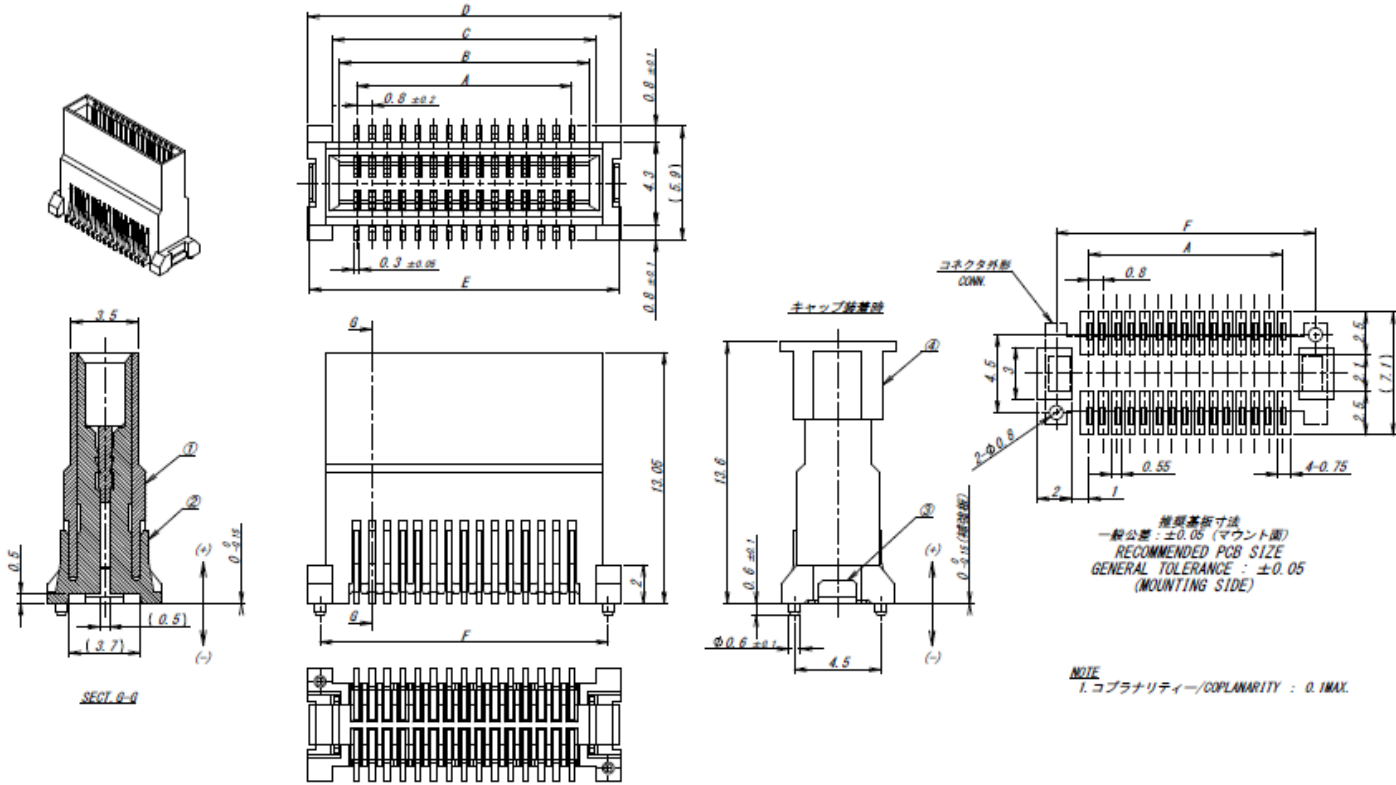

IRISO U.S.A., INC.

*Specification is subject to change without prior notice for improving performance of the product and so on.
*Dimension and specification described herein are limited to major items. When applying the products, please confirm details on drawing and specification sheets which will be provided upon request.

34405 West Twelve Mile Road, Suite 237 Farmington Hills, MI 48331, U.S.A.
TEL: 248-324-9780 FAX: 248-324-9783
<http://www.iriso.co.jp/en/>